

NEW!



Panasonic AG-AF100とのジョイント

MB-255は、PanasonicのAF100に対応できるマットボックスです。レンズ口径114mmまでに対応したマットボックスで、カールツァイス CompactPrime CP.2レンズにも対応したマットボックスです。また、デジタル一眼レフカメラレンズ用にも開発されています。ショルダーサポートを取り付けることで小型ビデオカメラにも対応して使用することができ、様々な撮影に幅広く対応できます。

素材は高品質のアルミニウム製で、自重は480gと非常に軽量化されており、耐久性もあります。グリップはオペレートしやすい角度に変えることができるため、撮影環境に応じて使用することができます。またそのグリップは握りも柔らかい革製です。

カメラサポートDSLRに、VocasのマットボックスやフォローフォーカスMFC-1などと合わせて使用することで、撮影をより円滑に、より快適に進められます。



構成図

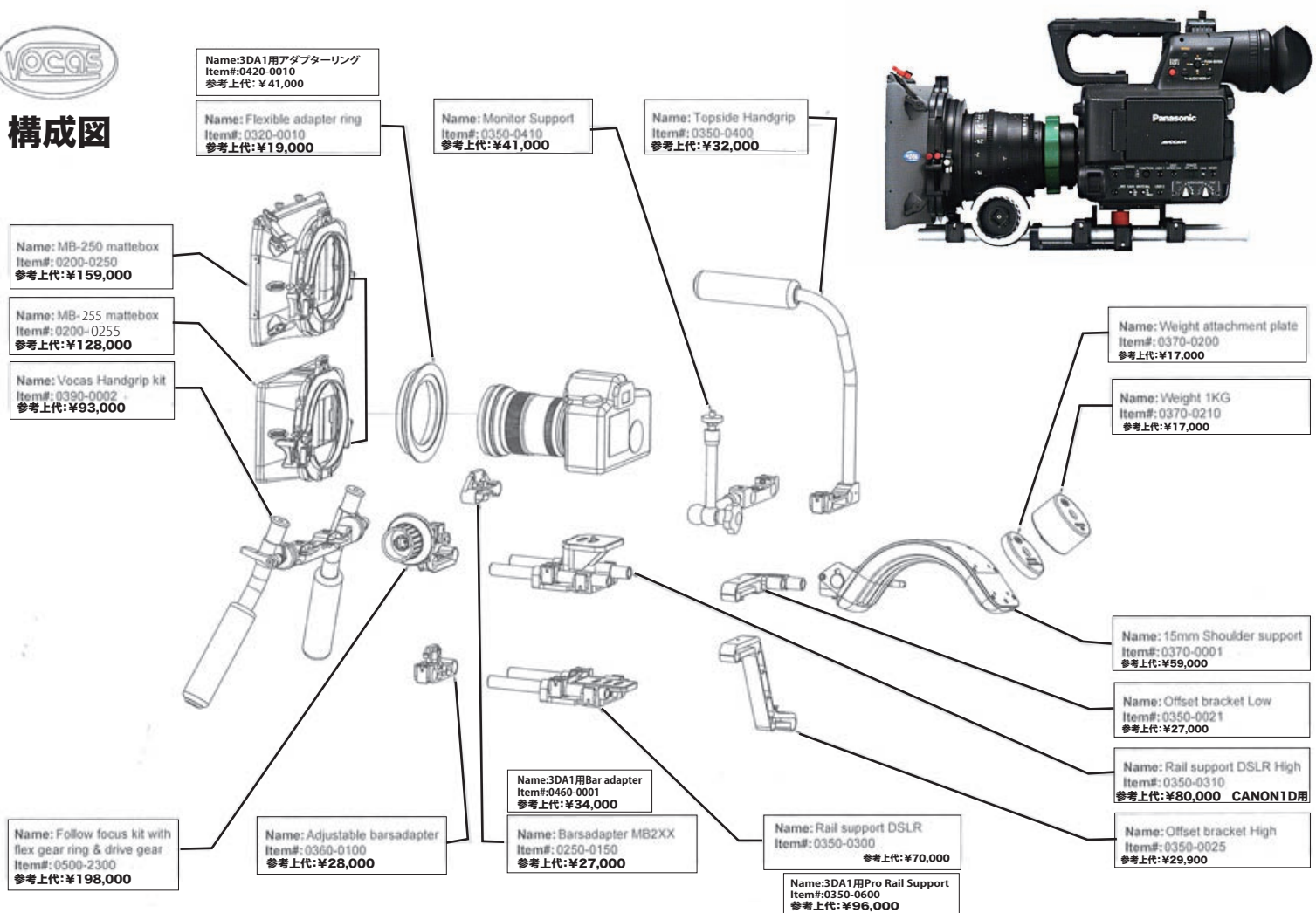

※本製品の仕様及び価格は、予告なしに変更することがございますのでご了承ください。



有限会社 シネマックス

〒359-0024 埼玉県所沢市下安松901-46

TEL: 04-2944-4691 FAX: 04-2944-4801

e-mail: info@cinemax.jp

URL: <http://www.cinemax.jp>



MB-450 mattebox.

Full option, high-end production mattebox, two fully rotatable 3.65"x5.65" (or two 4"x5.65") filterframes, one non rotatable 4"x5.65" filterframe and one 4"x5.65" filter in the hood. Internal eyebrows and a foldable top flag. Max. lens diameter of 144mm.

#0400-0451

Barsadapter for MB-450.

Adapter with quicklock mechanism.

If a Vocas MB-450 mattebox is used on a standard 15mm lightweight rail support, this (or #0460-0200) adapter is always needed.

#0460-0001

Swing-away bracket for MB-450.

This bracket enables the user to quickly change lenses without having to disassemble the mattebox setup. If a Vocas MB-450 mattebox is used on a standard 15mm lightweight rail support, this (or #0460-0001) adapter is always needed.

#0460-0200

144mm adapter rings for MB-450.

Flexible adaptoring.

Soft rubber donut ring. Required if a mattebox is used on a rail support to fill the gap between the rear of the mattebox and the lens front. Max. lens diameter 138mm. This ring can hold an additional round 138mm filter.

#0420-0001

Adaptoring for Panasonic AG-3DA1.

Dedicated adapter ring for this camera only.

#0420-0010

For more MB-450 mattebox accessories, please see our website.

MB-210 mattebox.

Compact basic mattebox, one fully rotatable 4"x4" filterframe, and one 4"x4" filter in the hood. Max. lens diameter of 105mm. The French flag is optional.

#0200-0210

MB-250 mattebox.

Advanced compact mattebox, one fully rotatable 4"x4" filterframe, one 4"x4" non rotatable, internal eyebrows and a French flag. Max. lens diameter of 105mm.

#0200-0250

MB-255 mattebox.

Identical to the MB-250 but with a Max. lens diameter of 114mm. Including a step down ring to the Vocas 105mm. adapter ring system.

#0200-0255

Barsadapter for MB-2XX.

Height adjustable adapter with quicklock mechanism.

If a Vocas MB-2XX mattebox is used on a standard 15mm lightweight rail support, this adapter is always needed.

#0360-0100

105mm flexible adapter ring kit for MB-2XX.

Soft rubber donut ring. Required if a mattebox is used on a rail support to fill the gap between the rear of the mattebox and the lens front. For 105mm matteboxes. Maximum lens diameter 95mm.

#0320-0010

105mm adapter ring system for MB-2XX.

If a mattebox is used as a clip-on, an adaptor ring is required to attach the mattebox to the lens. An extensive range of different size rings is available. Please see the MB-2XX accessory page on our website www.vocas.com for more details.

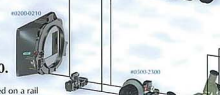
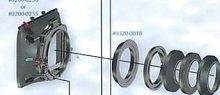
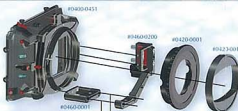

This 15mm lightweight rail support is compatible with many cameras such as the Panasonic AG-AF100(1), (not with the Panasonic AG-3DA1). And provides a stable platform for attaching multiple additional 15mm accessories. It includes a balance plate tripod attachment, allowing the user to position the camera on its centre of gravity when mounting it on a tripod. This rail support comes standard with a set of 15mm rails of 210mm in length.

#0350-0300

Pro rail support:

This double sided 15mm lightweight rail support is compatible with many cameras such as the Panasonic AG-AF100(1) and AG-3DA1. And provides an extremely stable platform for attaching multiple additional 15mm accessories. It includes an extra long balance plate tripod attachment, allowing the user to position the camera on its centre of gravity when mounting it on a tripod. This rail support comes standard with a set of 15mm rails of 350mm in length.

#0350-0600

15mm shoulder support:

A shoulder support that attaches directly to standard 15mm lightweight rails. This shoulder support features a thick rubber pad which lets even a heavy camera setup rest easily on one's shoulder. It can be adjusted in angle to accommodate different body types and features attachment points on the back for battery holders or counter weights. This shoulder support includes 350mm long rails, which is sufficient to mount the shoulder support in most setups.

#0370-0001

15mm offset bracket:

Specifically made for use with the Vocas 15mm shoulder support and a mid-size video camera. This offset bracket moves the shoulder support more to the right side of the eye of the camera, so the viewfinder is placed in front of the eye of the camera man. This item comes with two pieces of 15mm rails of 143mm in length, to allow the shoulder support to move more towards or away from the camera.

#0350-0021

Battery adapter plate:

For attaching the different brand's V-lock battery mount plates directly on the back of the Vocas 15mm shoulder support (instead of the counter weights).

#0370-0100

Shoulder support counter weight:

Specifically made for use with the 15mm shoulder support. This counter weight system comprises of an attachment plate, which is mounted directly to the back of the shoulder support, and stackable 1kg stainless steel weights.

Weight attachment plate for Vocas shoulder support.

#0370-0200

Weight 1kg for Vocas Shoulder support.

#0370-0210

Handgrip set:

This handgrip set fits on any 19mm and 15mm lightweight rails and is ideal for use with the Vocas Shoulder bracket. The handgrips can easily be rotated, positioned and tilted to assume the perfect position for any situation.

Handgrip kit, including one handgrip

#0390-0001

Handgrip kit, including two handgrips

#0390-0002

15mm rails.

Vocas has an extensive range of various lengths of 15mm rails available, ranging from 35mm to 400mm. Please see the MB-2XX accessory page on our website www.vocas.com for more details.

Follow focus MFC-1.

This compact follow focus system, the MFC-1, enables the cameraman to control the focus with more precision. Attaches directly to any 15mm lightweight support with a quick-lock clamping. Not compatible with the Panasonic AG-AF100(1).

#0300-0001



Ready to use kits:

Ordernr:	Description:
0455-2100	MB-450 mattebox kit for Panasonic AG-3DA1. Consisting of:
0400-0451	MB-450 mattebox.
0460-0001	Barsadapter for MB-450 for 15mm rails.
0420-0010	Adapting for Panasonic AG-3DA1.

0255-2000	Compact MB-255 mattebox kit for Panasonic AG-AF100(1). Consisting of:
0200-0255	MB-255 mattebox, including 114mm to 105mm step down ring
0360-0100	Barsadapter for MB-2XX for 15mm rails.
0320-0010	105mm flexible adapting kit for MB2XX.

0455-2000	High end production mattebox kit for Panasonic AG-AF100(1). Consisting of:
0400-0451	MB-450 mattebox.
0460-0200	Swing-away bracket for MB-450 for 15mm rails.
0420-0001	144mm flexible adapting kit for MB450.

0255-3600	Handheld kit for any of the above three mattebox kits. Consisting of:
0390-0002	Handgrip set, including two handgrips.
0330-0021	15mm offset bracket.
0370-0200	Weight attachment plate for Vocas shoulder support.
0370-0210	Weight 1kg. Stackable, add more if you like.
0350-0600	Pro Rail support.
0370-0001	15mm shoulder support.

0500-2300	MFC-1 follow focus kit for any camera with 15mm LW support. Consisting of:
0500-0001	MFC-1 follow focus.
0500-0290	Flexible gear ring kit, for all cylindrical focus barrels with an outside diameter between 40mm and 100mm. Tooth size M0,8.
0500-0101	Drive gear, tooth size M0,8, 46 teeth.



Video Optic Cine Audio Systems
The Vocas camera support system.

November 2010



Panasonic

For more available accessories and detailed information please see our website.
 A full product catalog is available for download at: www.vocas.com/documentation.htm
WWW.VOCAS.COM

PO Box 191, 1200 AD, Hilversum, Nederland
 Tel: +31(0)35-6233707, Fax: +31(0)35-6233997
 e-mail: info@vocas.com, Web: www.vocas.com

Ultimate light management